

# CO-10 Installation Guide

## Electronic Pulse Counter

1. DIN48 X 24mm
2. Internal battery life 2 - 5 years
3. Error rate  $\leq 0.02\%$
4. LCD display with 6 digits (font size is 6.7mm height) or 8 digits (font size is 8.6mm height)
5. No mechanical wear
6. Max. resistance when terminals are close:  $\leq 10\text{km}$
7. Min resistance when terminals are open:  $\geq 500\text{km}$
8. Minimize signal pulse width  $\geq 0.2\text{s}$
9. Weight: about 60g
10. Hole size 22.2 X 45 mm
11. Can reset on panel or by external terminal
12. Use ambient temperature:  $-10 \sim 60^\circ\text{C}$

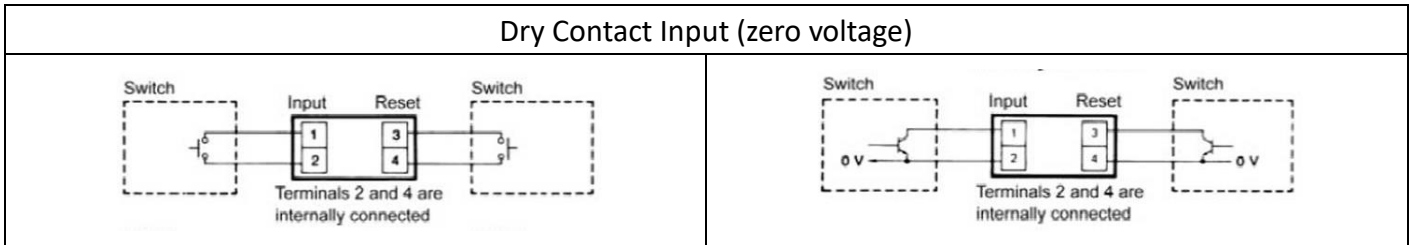

Display mode	LCD	
Reset mode	External / Panel	
Display the number of digits	6 digits (font size is 6.7mm height)	
Counting input	Dry contact input (No voltage) like Reed Switch	
Reset input	Dry contact input (No voltage) like Reed Switch	
Counting speed	20ms	

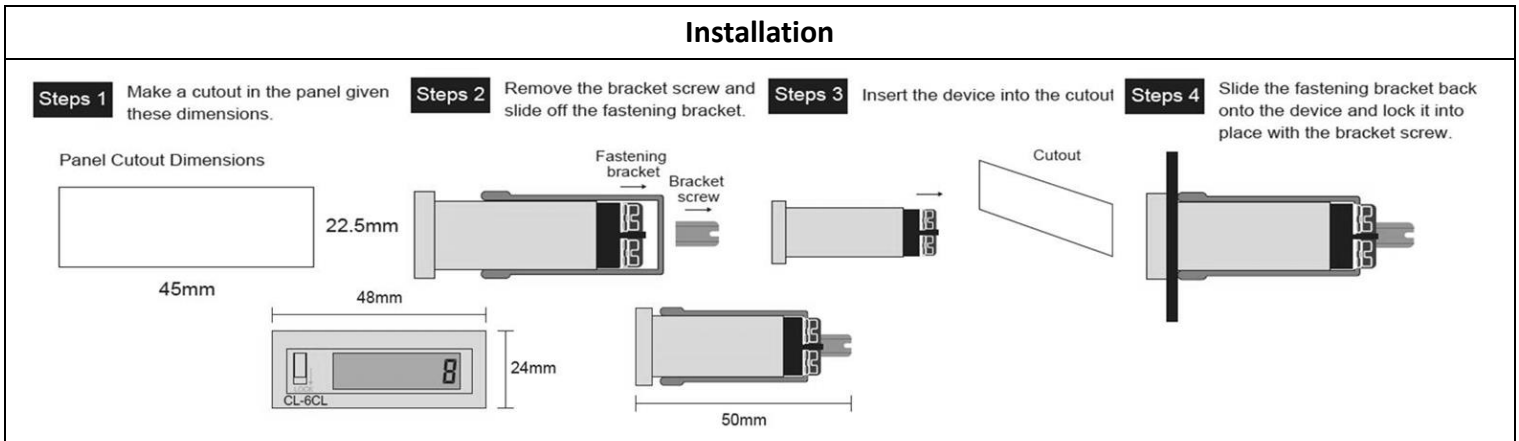

### NOTE

1. UL 2464 24 AWG, shielded twisted pair cable is suggested to connect the Electronic Pulse Counter and Water Meters.
2. Slide up and push the button to reset to 0. After the reset, slide down the button. If somebody push the button mistakenly, it will not be reset to 0.

**WARNING:** A lithium-ion battery inside. Do not make it stay in high pressure or overheat environment.